



# PC Plast® SB 34

Waterproofing membrane applied using torch.

PC Plast® SB 34 is a modified bitumen membrane incorporating SBS, tailored to function as the foundational layer in a two-layer roofing system for a variety of structures. This versatile material is well-suited for waterproofing foundations and engineering structures, and can also serve as an underlayment for bitumen shingles on sloped roofs, whether in new constructions or repair projects. Its durability enables it to withstand fluctuating temperatures and heavy loads, ensuring enduring and reliable waterproofing. Enhanced by SBS polymer, it offers flexibility and resilience. Noteworthy features include a bottom side with a polymer film bearing distinctive graphic elements that melt to indicate proper heating, while the top side is shielded by a polymer film.

## GENERAL REQUIREMENTS:

- Store the material rolls indoors in a dry environment, maintaining them in their original packaging. During transportation to the construction site, ensure readiness for immediate use.
- Store the rolls in an upright position, refraining from stacking pallets.
- Prepare the application surface by clearing it of dust, debris, grease, leaves, oil, gaps, cracks, or any irregularities to promote optimal adhesion of the membrane.
- Apply a primer to the surface prior to the installation of the waterproofing material.

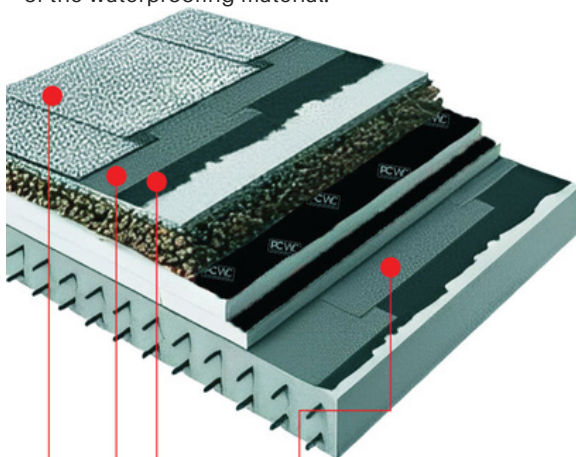

PC-Self® XL  
 PC-Prime® 01  
 PC Plast® SB 34  
 PC-Plantoper® Geo

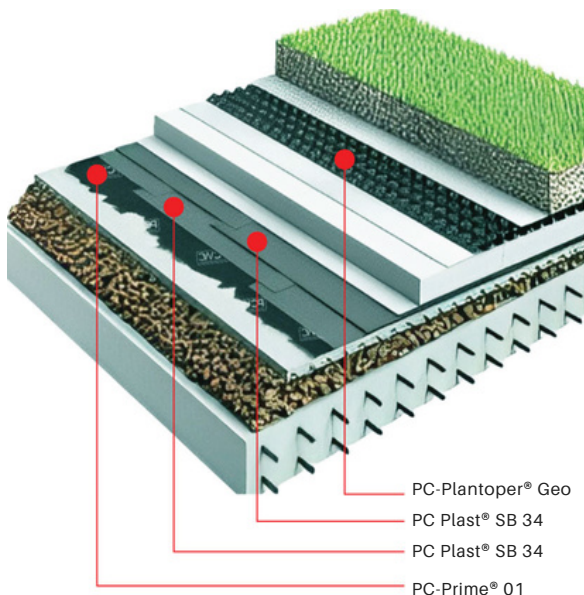

PC-Plantoper® Geo  
 PC Plast® SB 34  
 PC Plast® SB 34  
 PC-Prime® 01

## INSTALLATION

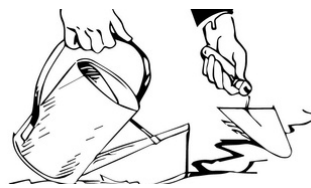

Thoroughly clean the surface, addressing any gaps, cracks, or imperfections, and ensure it is level and dry before proceeding.



For improved adhesion of the bitumen membrane, it is recommended to apply a bitumen primer to the surface.

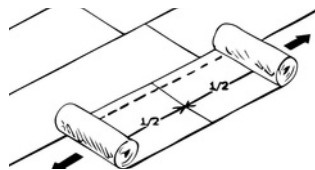

Roll out the membranes and align them before tightly rolling them from both sides toward the center.



Heat both the upper and lower surfaces of the material simultaneously to induce a gentle flow of bitumen.



Heat the material and the base evenly across the entire width of the roll, with particular attention to providing additional heat at overlapping sections.

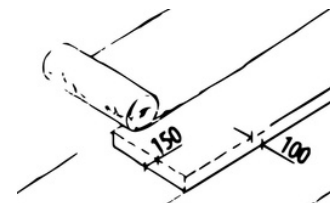

Longitudinal overlaps should measure 100 mm, whereas end overlaps should be at least 150 mm.

## SYSTEM SOLUTIONS

FOUNDATION WITH THERMAL INSULATION

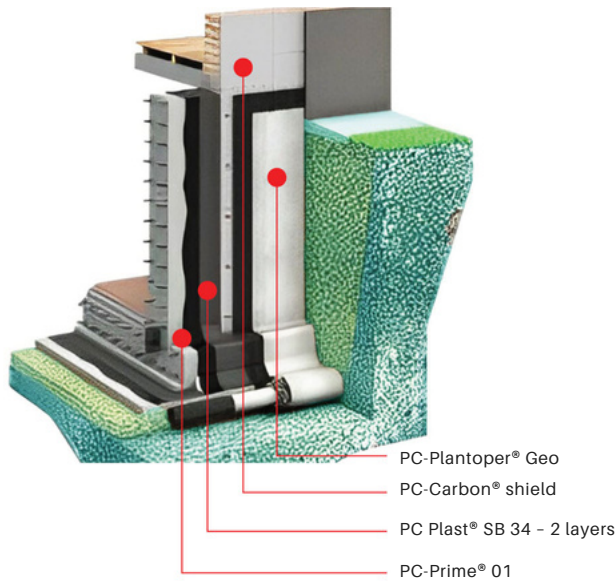

FOUNDATION WITHOUT THERMAL INSULATION

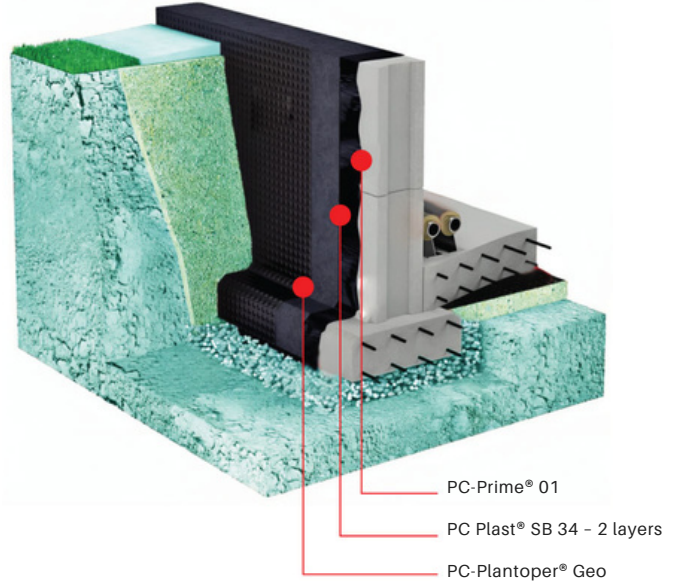

## DECLARED PERFORMANCE

Essential characteristics	Test Method	Performance	Essential characteristics	Test method	Performance
Protection of the top side	-	polymer film	Softening point, °C	ASTM D36	≥+145
Protection of the bottom side	-	polymer film	Flexibility at low temperature, °C	EN 1109-1	≤-2
Length, m	EN 1848-1	≥15.0 (2 mm thick) ≥10.0 (3 mm thick) ≥10.0 (4 mm thick)	Flow resistance at elevated temperature, °C	EN 1110	≥+120
Width, m	EN 1848-1	≥1.0	Watertightness at 0.1 MPa for 24 hours	EN 1928	Pass
Straightness	EN 1848-1	≤10 mm / 5 m	External fire performance	EN 13501-5	NPD
Mass per unit area, kg/m <sup>2</sup>	EN 1849-1	2.8±0.28 3.8±0.38 5.1±0.48	Reaction to fire	EN 13501-1	Euroclass E
Thickness, mm	EN 1849-1	2.0±0.20 3.0±0.20 4.0±0.20	Dimensional stability, %	ASTM D5147	1.0
Type of carrier	-	polyester	Adhesion of granules, %	EN 12039	1.0
Tensile properties: maximum tensile force L / T, N/50mm	ASTM D5147	850±170 / 650±130	Visible defects	EN 1850-1	pass
Tensile properties: elongation L / T, %	ASTM D5147	45±9 / 50±10	Water vapor transmission properties	EN 1931	μ=20000
Tear resistance L / T, N	ASTM D4073	350±100 / 350±100	Dangerous substances	Does not contain dangerous substances	Does not contain dangerous substances

Footnotes: L / T - Longitudinal / Transverse; NPD - No Performance Determined.

Shelf life if all storage requirements are met: 12 months from the date of production.



### PC-WC GLOBAL FZ-LLC

Compass Building, Al Shohada Road Al-Hamra industrial Zone-FZ,  
Ras Al- Khaimah, UAE  
Email : info@pc-wc.com  
Phone +971542455817 , www.pc-wc.com

TECHNICAL DATA SHEET UPDATED IN  
SEPTEMBER 2020  
TDS/PC PLAST® SB 34/20

All technical data in this Product Data Sheet are based on laboratory tests. Actual measured data may vary due to circumstances beyond our control.

The information, particularly the recommendations relating to the application and end-use of PC-WC products, are given in good faith based on PC-WC's current knowledge and experience of the products when properly stored, handled and applied under normal conditions by PC-WC recommendations. In practice, the differences in materials, substrates and actual site conditions are such that no warranty in respect of merchantability or of fitness for a particular purpose, nor any liability arising out of any legal relationship whatsoever, can be inferred either from this information, or from any written recommendations, or any other advice offered. The user must test the product's suitability for the intended application and purpose. PC-WC Global FZ-LLC reserves the right to change the properties of its products. The proprietary rights of third parties must be observed. All orders are accepted subject to our current terms of sale and delivery. Our technical assistance is at the disposal of the users. Consult the latest update of the technical data sheet on our [website www.pc-wc.com](http://www.pc-wc.com)